

AMERICAN CLASSIC BARN, Inc.

P.O. Box 187 ■ Masonville, CO 80541

(970) 669-0777 ■ www.AmericanClassicBarns.com

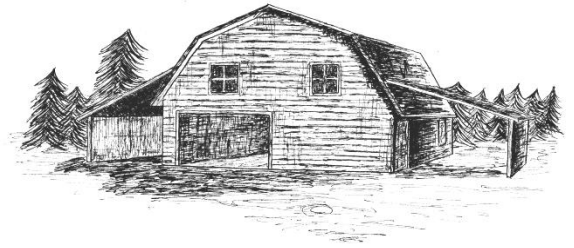

SEDONA HILLS STORAGE SHED



This attractive yet simple storage shed provides room for equipment and hay bales. It can also be used as a loafing shed for horses with up to 4 individual stalls. The outside dimensions are 26' x 40' with a wall height of approx. 11'. Siding is rough sawn pine, board and batten with a steel roof.



All designs shown are the property of American Classic Barns, Inc. and cannot be used, in part or whole, without express written permission from American Classic Barns, Inc., P.O. Box 187, Masonville, CO 80541.

SEDONA HILLS STORAGE SHED FLOOR PLAN

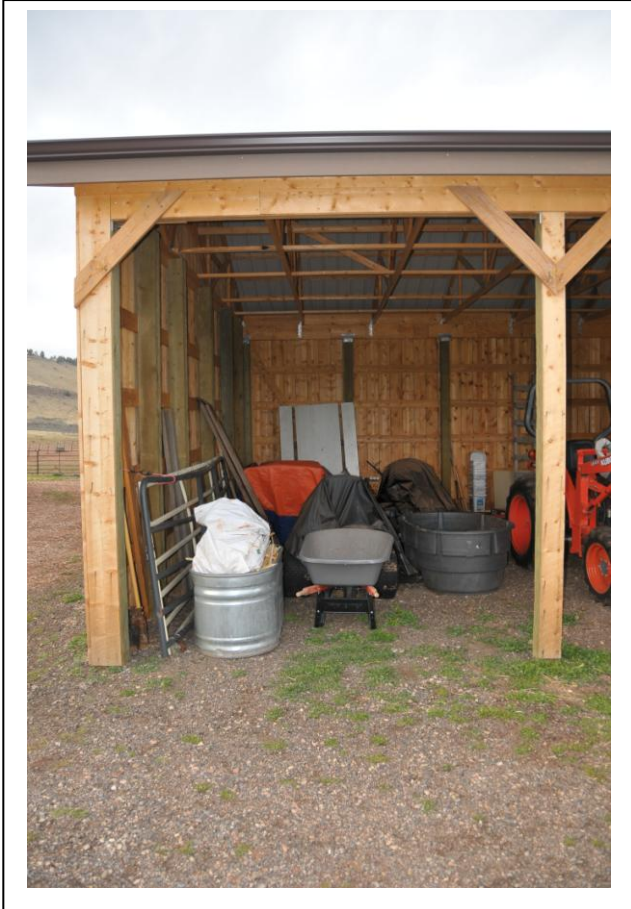
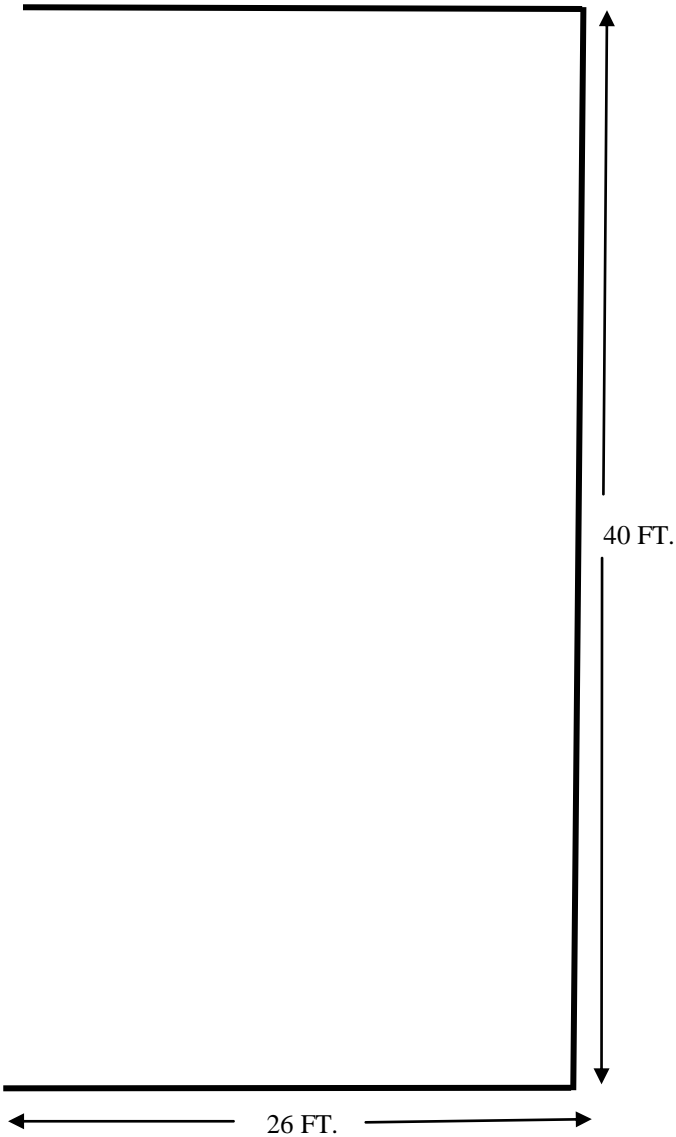

All designs shown are the property of American Classic Barns, Inc. and cannot be used, in part or whole, without express written permission from American Classic Barns, Inc., P.O. Box 187, Masonville, CO 80541.