

# **MERICAN CLASSIC BARNs, Inc.**

P.O. Box 187 ■ Masonville, CO 80541  
(970) 669-0777 ■ [www.AmericanClassicBarns.com](http://www.AmericanClassicBarns.com)



## **BAXTER LAKE BARN**



**BEFORE**



**AFTER**

**T**ransform an open sided loafing shed to a fully enclosed storage shed. A mirror image of the existing shed was created and new siding, wall light panels and doors were installed.

East and west ends of the building have entrance doors while the front has 2 large steel slider doors and one overhead garage door in the middle between them.



# BAXTER LAKE BARN FLOOR PLAN

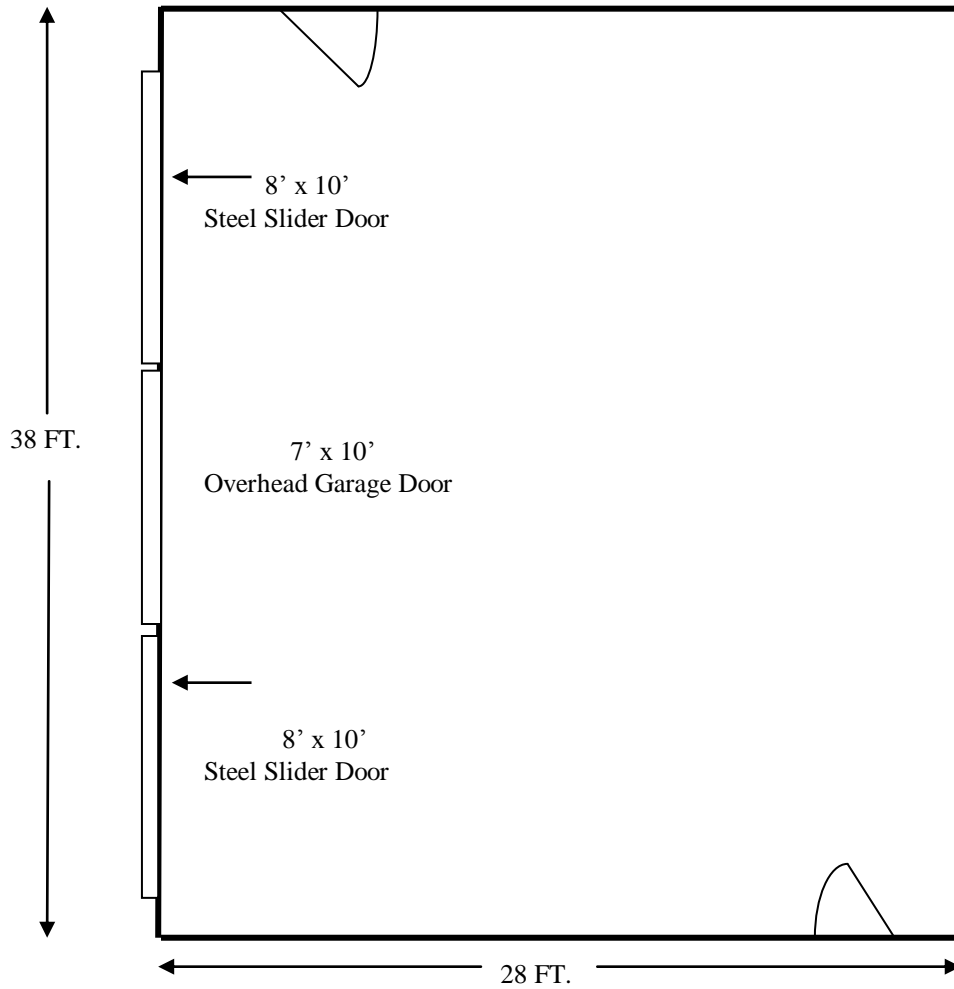

All designs shown are the property of American Classic Barns, Inc. and cannot be used, in part or whole, without express written permission from American Classic Barns, Inc., P.O. Box 187, Masonville, CO 80541.